

Basic series
5 mm embeddable

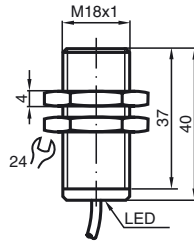

General specifications	
Switching element function	DC Make function
Rated operating distance s_n	5 mm
Installation	embeddable
Assured operating distance s_a	0 ... 4.05 mm
Reduction factor r_{Al}	0.34
Reduction factor r_{Cu}	0.31
Reduction factor r_{V2A}	0.72
Nominal ratings	
Operating voltage U_B	5 ... 60 V
Switching frequency f	0 ... 500 Hz
Hysteresis H	1 ... 10 typ. 5 %
Reverse polarity protection	tolerant
Short-circuit protection	pulsing
Voltage drop U_d	≤ 5 V
Operating current I_L	2 ... 100 mA
Off-state current I_r	0 ... 0.5 mA typ.
Indication of the switching state	all direction LED, yellow
Standard conformity	
Standards	EN 60947-5-2:2004
Ambient conditions	
Ambient temperature	-25 ... 70 °C (248 ... 343 K)
Mechanical specifications	
Connection type	2 m, PVC cable
Cable version	PA
Core cross-section	0.34 mm ²
Housing material	brass, nickel-plated
Sensing face	PBT
Protection degree	IP67

Connection type:

Z0

